

	Eastern Veterans Cycling Club		
	Dunlop Road Criterium Course Traffic Management Plan		
	Audited By:	Signed:	Date:
	Drawing Reference Course Overview	Drawn: Hylton Preece	Date: 08/02/09
	Signed:	Date:	

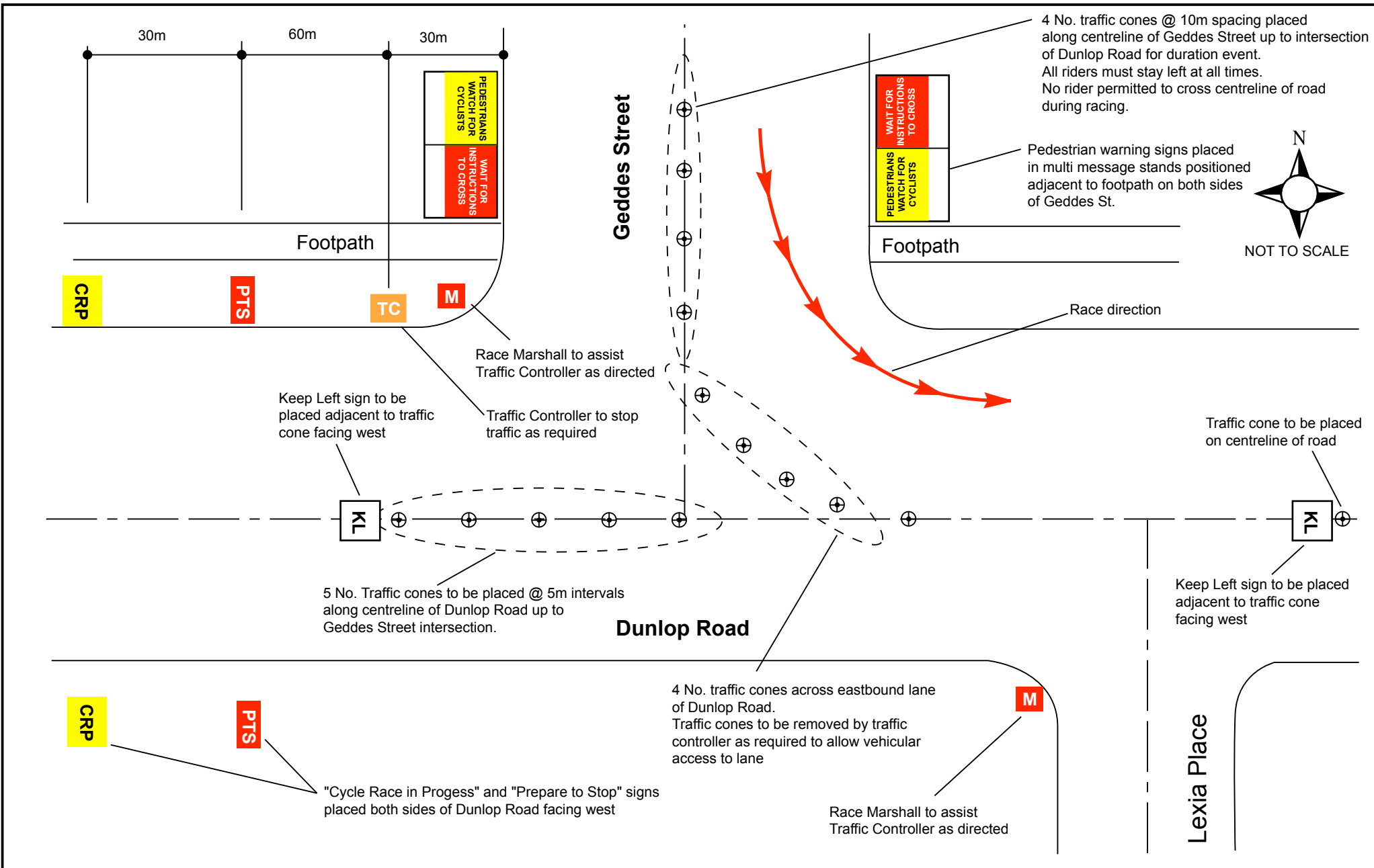

4 No. traffic cones @ 10m spacing placed along centreline of Geddes Street up to intersection of Dunlop Road for duration event. All riders must stay left at all times. No rider permitted to cross centreline of road during racing.

Pedestrian warning signs placed in multi message stands positioned adjacent to footpath on both sides of Geddes St.

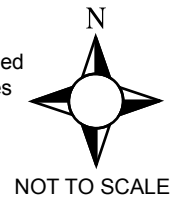

Keep Left sign to be placed adjacent to traffic cone facing west

Race Marshall to assist Traffic Controller as directed
Traffic Controller to stop traffic as required

5 No. Traffic cones to be placed @ 5m intervals along centreline of Dunlop Road up to Geddes Street intersection.

Dunlop Road

4 No. traffic cones across eastbound lane of Dunlop Road. Traffic cones to be removed by traffic controller as required to allow vehicular access to lane

"Cycle Race in Progress" and "Prepare to Stop" signs placed both sides of Dunlop Road facing west

Race Marshall to assist Traffic Controller as directed

	Eastern Veterans Cycling Club		
	Dunlop Road Criterium Course Traffic Management Plan		
	Audited By:	Signed:	Date:
	Drawing Reference Detail A	Drawn: Hylton Preece Signed:	Date: 08/02/09 Date:

4 No. traffic cones @ 10m spacing placed along centreline of McDonalds Lane up to intersection of Dunlop Road for duration event.
All riders must stay left at all times.
No rider permitted to cross centreline of road during racing.

Pedestrian warning signs placed in multi message stands positioned adjacent to footpath on both sides of Geddes St.

Footpath

Race direction

McDonalds Lane

30m

60m

30m

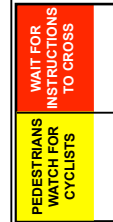
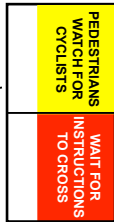

Footpath



Race Marshall to assist Traffic Controller as directed

Dunlop Road

5 No. Traffic cones to be placed @ 5m intervals along centreline of Dunlop Road up to McDonalds Road intersection.

"Cycle Race in Progress" and "Prepare to Stop" signs placed both sides of Dunlop Road facing east

4 No. traffic cones across eastbound lane of Dunlop Road.
Traffic cones to be removed by traffic controller as required to allow vehicular acces to northbound lane of McDonalds Lane

Traffic Controller to stop right turning westbound traffic traffic as required



NOT TO SCALE



Eastern Veterans Cycling Club

Dunlop Road Criterium Course Traffic Management Plan

Audited By:	Signed:	Date:
Drawing Reference Detail B	Drawn: Hylton Preece	Date: 08/02/09
	Signed:	Date:



NOT TO SCALE

Pickering Road

Dunlop Road

CRPs

"Cycle Race in Progress" (small) sign placed facing southbound traffic in Pickering Road.

Race Marshall to assist Traffic Controller as directed

5 No. traffic cones across both lanes of Pickering Road Traffic cones to be removed by race marshal as required to allow vehicular access to either Pickering Road or to Dunlop Road from Pickering Road

"Cycle Race in Progress" (small) signs placed both sides of Dunlop Road facing west and east

CRPs

M

Race direction



5 No. Traffic cones to be placed @ 5m intervals along centreline of Dunlop Road up to Pickering Road intersection.

CRPs

TC

Traffic Controller to control traffic entering/exiting Pickering Road



Eastern Veterans Cycling Club

Dunlop Road Criterium Course Traffic Management Plan

Audited By:

Signed:

Date:

Drawing Reference

Drawn: Hylton Preece

Date: 08/02/09

Detail C

Signed:

Date:



NOT TO SCALE

CRPs

Geddes Street

"Cycle Race in Progress" (small) sign placed both sides of Geddes Street facing eastbound and westbound traffic.

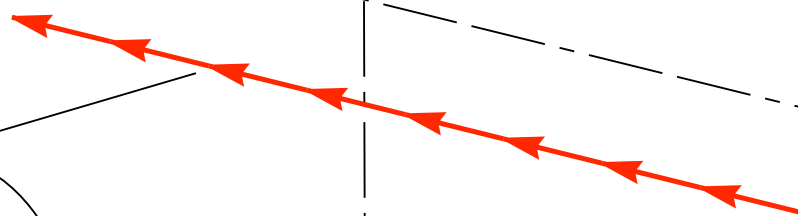

Race direction

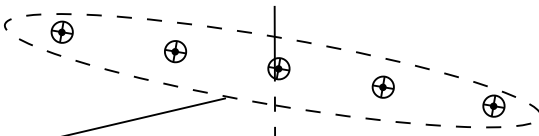

5 No. traffic cones across both lanes of Pickering Road Traffic cones to be removed by race marshall as required to allow vehicular access to either Pickering Road or to Geddes Street from Pickering Road

M

CRPs

Pickering Road

CRPs

"Cycle Race in Progress" (small) sign placed facing northbound traffic in Pickering Road.

	Eastern Veterans Cycling Club		
	Dunlop Road Criterium Course Traffic Management Plan		
	Audited By:	Signed:	Date:
	Drawing Reference Detail D	Drawn: Hylton Preece	Date: 08/02/09
	Signed:	Date:	